

Struck Corporation  
W51 N545 Stuck Lane  
PO Box 307  
Cedarburg, WI 53074

Phone: (262) 377-3300  
Email: parts@struckcorp.com  
Text: 262-233-4292

Abbreviated parts list for the MAGNATRAC MT1800  
\*\*All prices are subject to change daily.\*\* Thank you.

<u>Part#</u>	<u>Description</u>	<u>Pricing</u>
MT1L-10	9-1/2" Center Idler Wheel Assembly with NEW SPACING	\$122.16
MT1L-10A	Tube for center idlers, unpainted	\$13.94
MT1L-13	Rear Axle	\$62.89
MT1L-14	Front Axle	\$48.65
MT1L-17 Replaced by	#001030up 1/2" Track tension rod/bolt	\$28.87
MT1L-20 Replaced by	#000425 Drum, Brake, 4" OD x 1" Bore, Sprocket/Shaft. (transaxle)	\$30.48
MT1L-23 Replaced by	#000217 Clevis Yoke End 5/15-24 x 2-1/4" (Pin#002501)	\$7.75
MT1L-25 Replaced by	#000252kit Bearing kit - (1" ID x 2" OD) set screw and shell.	\$16.10
MT1L-30	Track Shoe only ***DOES NOT INCLUDE ANY INNER OR OUTER TRACK LINKS***	\$8.00
MT1L-33	4" Center Idler Wheel Assembly with NEW SPACING	\$114.69
MTIL- 35 Replaced by	#000429 Hand throttle control assembly with nut (universal cable)	\$25.30
MT1L-36 Replaced by	#000430 Choke cable push/pull control.	\$13.86
MT1L-41 Replaced by	#000441 Neutral safety switch.	\$15.00
MTIL-46 Replaced by	#000440 Leaf Spring.	\$15.67
MT1L-51 Replaced by	#000444 Ignition switch.	\$14.03
000228	Machine Key, 1/4" x 1/4" x 1"	\$2.00
000241 Replaced by	#000242 Washer, 18 GA x 7/8" ID x 1-1/2" OD	\$.74
000671D	7/8" x 1" x 1" Oilite Bearing	\$2.95
001204D	CA557 Track pin & cotter key (5/16" diameter)	\$6.40
002571-kit2	MT1800 New Style Flat Track with CA557 Chain	\$1855.00
TO6G18	Set of Grouser Shoes	\$429.00
000716	Steel Washer, 1"ID x 1-1/2" OD	\$.78
000728-E	Snap Ring, 7/8" ID	\$1.40
001142up	New Flat Track Pad.	\$4.10

Shipping costs will be added to your order amount. We accept Visa, Mastercard, American Express, Discover, Pay Pal and checks with a 2-week waiting period.

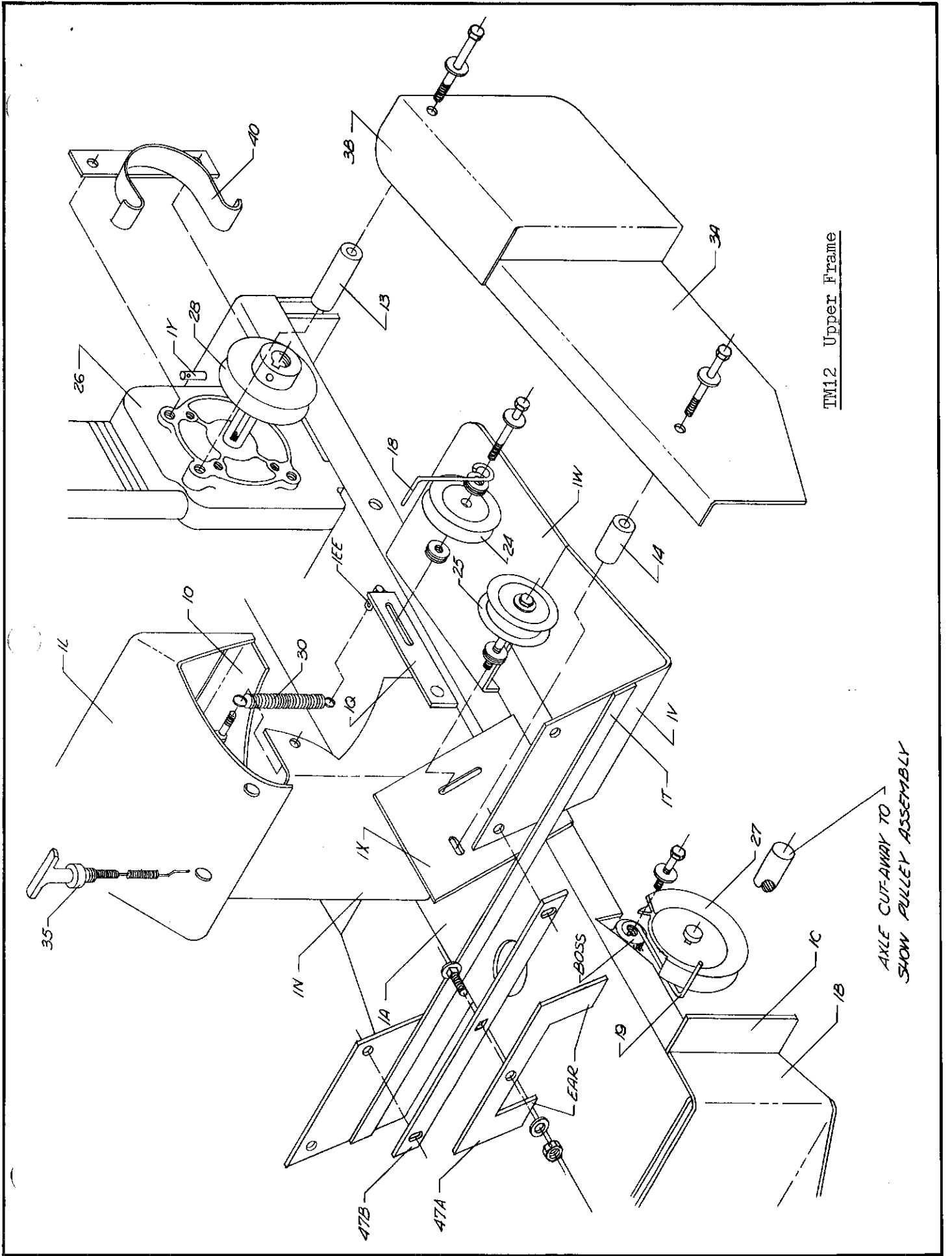

TM12 Upper Frame

AXLE CUT-AWAY TO SHOW PULLEY ASSEMBLY

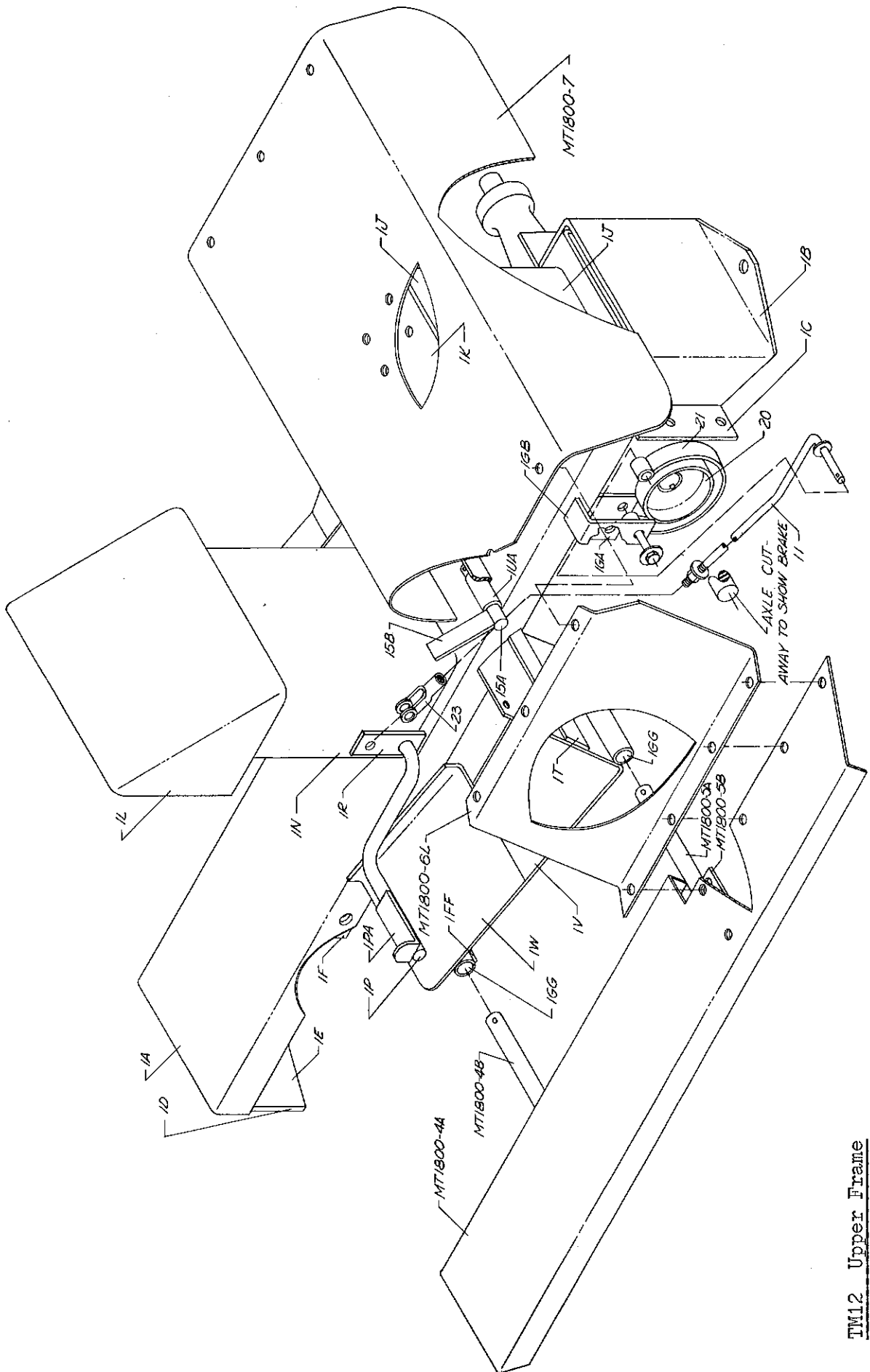

TM12 Upper Frame



